

TITANIUM

TECHNOLOGY

TT-P120



- Ideal for suspended ceilings and restricted place in clearance.

| | | | |
|-----------------------|---|--|--|
| Voltage | 120vAC | | |
| Power | 7W | 9W | 12W |
| Amperage | 0,05A | 0,08A | 0,11A |
| Angle | 120° | | |
| Lumen | 680lm | 800lm | 1000lm |
| CRI | 80 | | |
| Cut hole | 70mm 2 ³ / ₄ " | 105mm 4 ¹ / ₈ " | 156mm 6 ¹ / ₈ " |
| Finish | WH - White BK - Black | | |
| Dimmable | Yes | | |
| LED Colour | CCT - Blanc 2700K-3000K-3500K- 4000K-5000K | | |
| Operating temperature | -40°C~40°C | | |
| IP | 65 (wet location) | | |

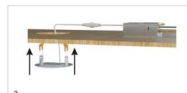
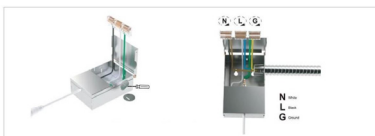

PRODUCT CODE

| TT | MODEL | POWER | FINISH | LED COLOUR |
|----|-------|-------|--------|------------|
| TT | P120 | 9W | BK | CCT |
| TT | P120 | | | CCT |